

## REAR SEAT DISASSEMBLY/ASSEMBLY

B3E091357200W02

1. Disassemble in the order indicated in the table.
2. Assemble in the reverse order of disassembly.

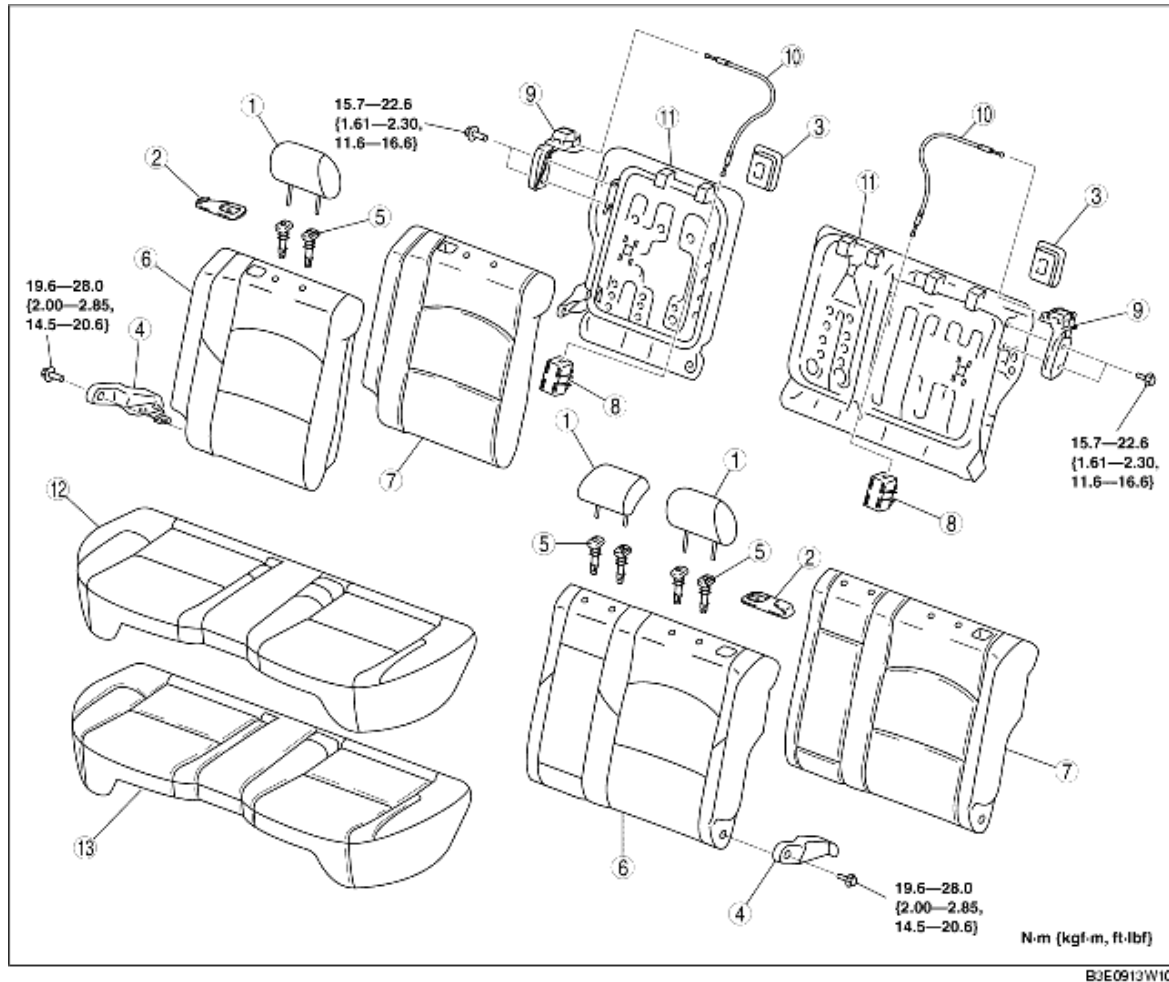

1	Headrest
2	Fold-down switch cover
3	Rear seat back lock cover
4	Rear seat back side hinge
5	Pole guide
6	Rear seat back trim
7	Rear seat back pad
8	Rear seat back lock
9	Fold-down switch
10	Remote wire
11	Rear seat back frame
12	Rear seat cushion trim
13	Rear seat cushion pad